

FOR LEASE

13,000 SF Flex Space - Provides Excellent Highway Access

214 CEDAR HILL STREET | MARLBOROUGH, MA



Building Specifications:

Available Space: 13,000 SF (Divisible) - Space has 3,000 SF of office space.

Some outdoor storage available.

Ceiling Height: 18'

Loading: 1 drive in and 1 tailboard dock

Asking Rent: Please call for pricing details.

Features:

- Cedar Hill Street provides excellent highway access and flexibility for area commuters. The property is ideally located within ½ mile of Routes 20 and 495.
- Easy access to the Massachusetts Turnpike and I-290.
- Professionally managed and maintained. Building has a new roof and HVAC.
- Join many of the fastest growing companies and well known companies in the region including: BlueCod Technologies, Sepaton, Ken's Foods, EMC Corporation, Verizon, Sepracor among others.
- Area amenities include hotels, restaurants, banks and convenience retail.
- Situated in the I-495 corridor, Marlborough offers several attractive features to companies: lower labor costs, abundant housing, less traffic congestion.



For information, contact:

Victor Galvani
Parsons Commercial Group
T 508.271.9225
vgalvani@pcg-ma.com



www.pcg-ma.com

FOR LEASE

13,000 SF Flex Space - Provides Excellent Highway Access

214 CEDAR HILL STREET | MARLBOROUGH, MA

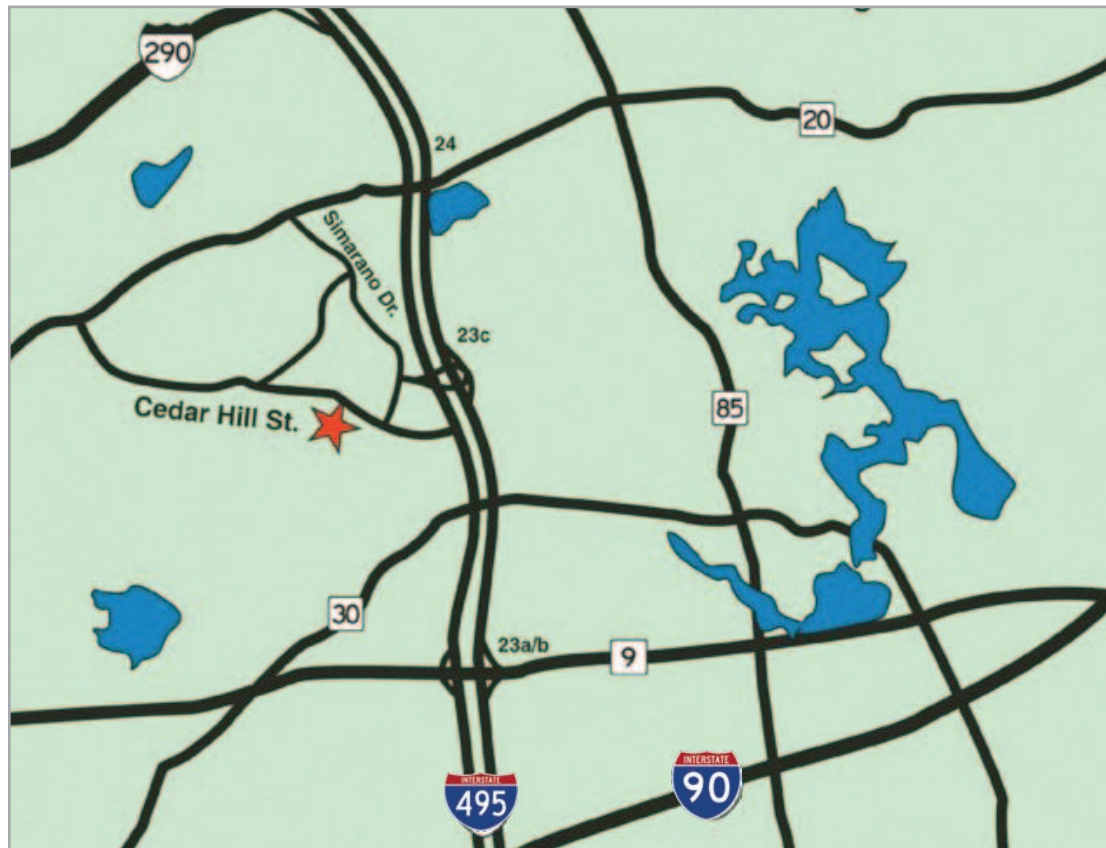

For information, contact:

Victor Galvani
Parsons Commercial Group
T 508.271.9225
vgalvani@pcg-ma.com



www.pcg-ma.com

Every effort has been made to furnish the most accurate information available on this property. However, all statements and conditions herein are subject to errors, omissions or removal from the market without notice.

FOR LEASE

13,000 SF Flex Space - Provides Excellent Highway Access

214 CEDAR HILL STREET | MARLBOROUGH, MA

Available Space Can Be Subdivided
up to 13,000 SF Available

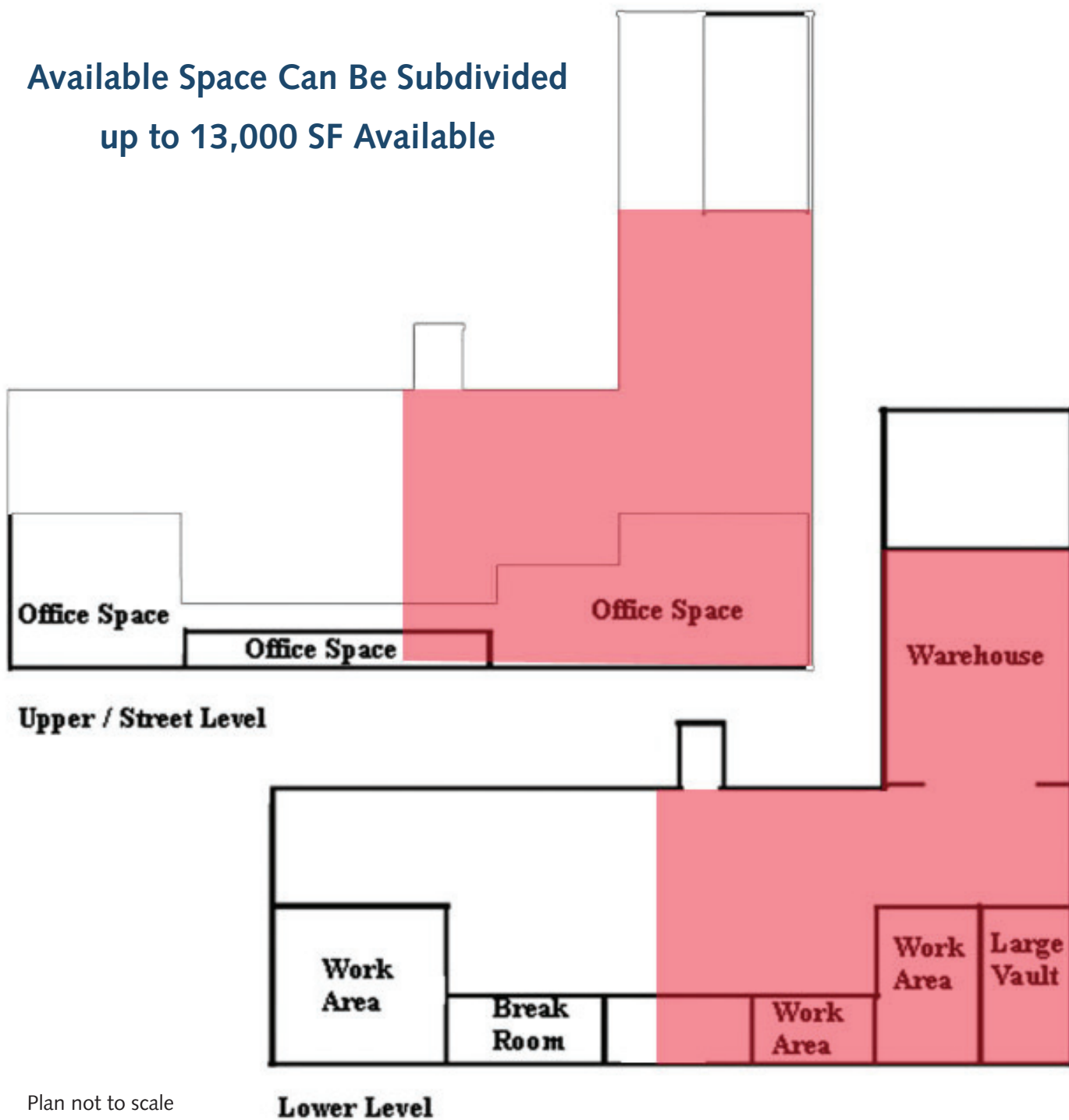

Plan not to scale